

# GLENDALE RV



## 10W

PARK MODEL

10' WIDE

2009 MODEL

YEAR

By Glendale RV

www.glendalerv.com

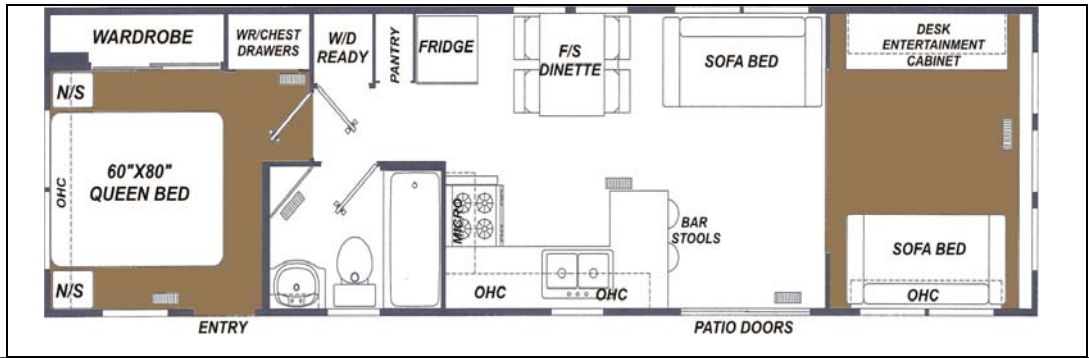

INTERIOR HEIGHT	MAIN BODY WIDTH	OVERALL HEIGHT	OVERALL LENGTH (with hitch)	OVERALL LENGTH (without hitch)
96"	10'	13'-1"	41'-9"	38'-3"

### CONSTRUCTION

**SIDEWALLS:** 2"x3" sidewall framing. Thick fiberglass batt insulation and 6 mil vapor barrier blankets the sidewall structure. All framework is positioned at 16" O.C. construction standards. Aluminum exterior siding (.025) included baked enamel smooth finish with built in UV shielding to provide years of high luster appearance and "Easy Clean" finish surface.

**ROOF:** Quiet, durable, and seamless rubber roof membrane is bonded to 3/8" decking. Full 5 1/2" tapered crown roof structure provides outstanding strength and superior water drainage. Tapered bow truss framing. Thick fiberglass batt insulation.

**FLOOR:** 5/8" decking screwed and glued to 2"x4" main floor frame. Seamless Seamless Darco polyethylene moisture barrier between chassis and floor.

**CHASSIS:** Removable hitch assembly 12" "1" beam steel frame construction. Specially formulated chassis undercoating provides many years of corrosion and paint protection.

**INTERIOR CABINET DOORS:** Arch styled Beeched colored cabinet doors with antique brass hardware. T&G interlocking cabinet door miters. Cabinets feature center shelves for stacking convenience. "Easy-Glide" metal roller system on all drawers.

**WINDOWS & EXTERIOR DOORS:** White vinyl trimmed residential style windows with storms and shutters. 5' thermo pane patio door with screen and night latch lock assembly. 30" wide combination residential style metal white entry door.

### APPLIANCES

**REFRIGERATOR:** Large top freezer style residential GE 16 cubic ft capacity.

**RANGE:** GE 24" free standing residential style range, white finish, black glass oven door

**FURNACE:** Hydro Flame auto ignition 40,000 BTU ducted in-floor heat system.

**MICROWAVE OVEN:** 30" White GE programmable microwave includes turntable, and built in range hood..

**AIR CONDITIONER:** Dometic 15,000 BTU thermal insulated ducted in ceiling cool air system.

### SAFETY

Smoke detector, fire extinguisher, G.F.I. protected exterior weather receptacle and G.F.I. protected bathroom vanity area receptacle.

### ENTERTAINMENT

**TELEPHONE JACK:** 3 Standard Equipment.

**TV HOOKUP:** Bedroom and Living room hookups.

**SATELLITE HOOKUP:** Model is pre-wired for quick dish connection.

### PLUMBING

House type toilet, large white deep double sinks (included cover) in kitchen. Lyons tub and Surround, Water filtration system, Bath vanity with white sink and single lever antique brass faucet.

**WATER HEATER:** Atwood fast recovery 10 gal. LP/Electric operation.

### ELECTRICAL

Exterior courtesy light and switch at patio door.

Exterior and interior G.F.I. circuits.

**HOOKUP:** 50 Amp.

### STANDARD FEATURES

Coil inner spring 60"x80" queen mattress with pillow shams and bedspread, square pedestal oak finished free standing dinette, 2 residential style sofa bed with 60"x80" inflatable bed and convenient under sofa storage 110V lighting, Day/Night shades, 2 bar stools, antique brass hardware, Wardrobe wire shelf, night tables, exterior window shutters, washer dryer ready, plush carpeting with premium under pad in the bedroom area Living room area.

### OPTIONAL EQUIPMENT

22' A&E Pewter/White Awning with center rafter Ceiling fan with lights, RV toilet with septic tank with foot pedal and hand sprayer.

\* All specifications subject to change without notice or obligation 11/01/2008